



# ASSISTED LIVING FACILITIES

Assisted living operators choose to build with Element ICF because it's not just a SMART build—it's also a SMART business strategy

## HIGH PERFORMANCE ADVANTAGES

- Element ICF, with "6 Steps in 1", saves time and money. And a faster build means earlier occupancy and a quicker positive cash flow.
- Element ICF walls are bullet-proof, and, when hurricane glass is installed, during most storms your occupants can safely remain in the building without having to be moved. That means family members will enjoy peace of mind knowing their loved ones are in a safe and comfortable environment.
- The enhanced living experience of a Element ICF-built structure provides you with a strategic opportunity to charge a bit more money in return for the added value it offers, while the ongoing savings you'll experience in energy and maintenance expenses will perpetually drop to your bottom line.



## LOGIX BRANDS IS THE ICF SOLUTIONS COMPANY

Logix Brands provides full-service support and turn-key expertise to designers, GC's and installers to shorten the learning curve and maximize project success.

- Design Assistance
- Crew-Specific Training & On-site QC
- ICF Advisory Services

**CONTACT US** for more information or to arrange a meeting with a Element ICF Technical Advisor.

info@elementicf.com 888.415-6449  
 ElementICF.com

## SIX CONSTRUCTION STEPS IN ONE EFFICIENT PACKAGE

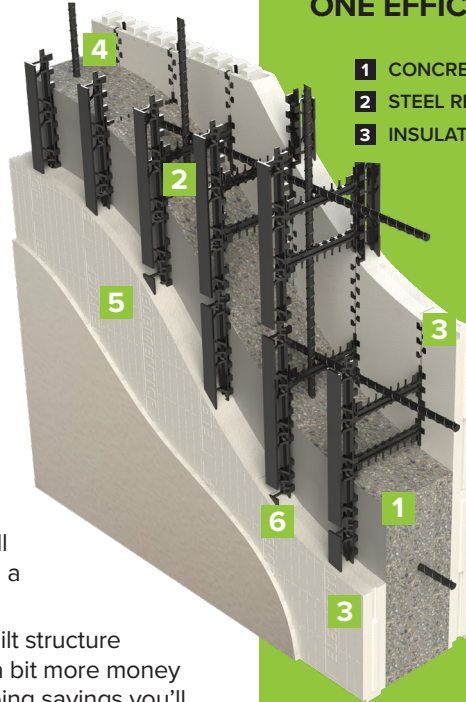

- |                              |                         |
|------------------------------|-------------------------|
| <b>1</b> CONCRETE            | <b>4</b> AIR BARRIER    |
| <b>2</b> STEEL REINFORCEMENT | <b>5</b> VAPOR BARRIER  |
| <b>3</b> INSULATION          | <b>6</b> FURRING STRIPS |



## EXCEPTIONAL SOUND-PROOFING

Your occupants will notice and appreciate the additional sound control and privacy that an Element ICF building provides.

Element ICF Delivers More R-Value And Additional Energy Savings.

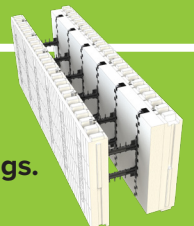

Complete The Efficient ICF Envelope By Framing All Openings With Element Pro Buck<sup>™</sup>

Important Disclaimer: Some of the images contained herein are of projects built using Logix ICF and are shown solely for illustrative purposes of an ICF system. These images are based on Logix ICF, and may not be relied upon in connection with a build using Element ICF. No guarantee, warranty, or representation whatsoever is made that Element ICF will be available as depicted, or, if available, will be of the same type, size, quality, location, or nature as depicted or illustrated in the images and videos contained herein.

© Copyright Logix Brands Ltd. (2024) All rights reserved. No part of the work contained herein as covered by this copyright may be reproduced or used in any form, or any means – graphic, electronic or mechanical, including without limitation photocopying. By using these products, you agree to assume all risks associated therewith. See LogixBrands.com/Disclaimer-General for a full copy of disclaimer.